

REVISION RECORD				
REV	ECO	DESCRIPTION	DRFT	CHKD
△		DRAWING MODIFY	Qionpu 4/21/03'	
△		Add P/N	sammy 08/06/04	
△		NOTES MODIFY	Among 10/22/04	

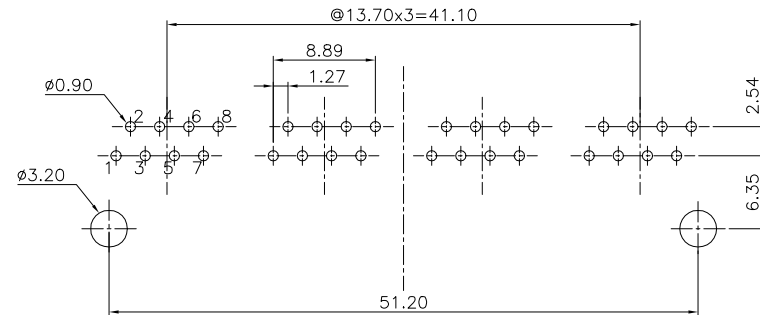
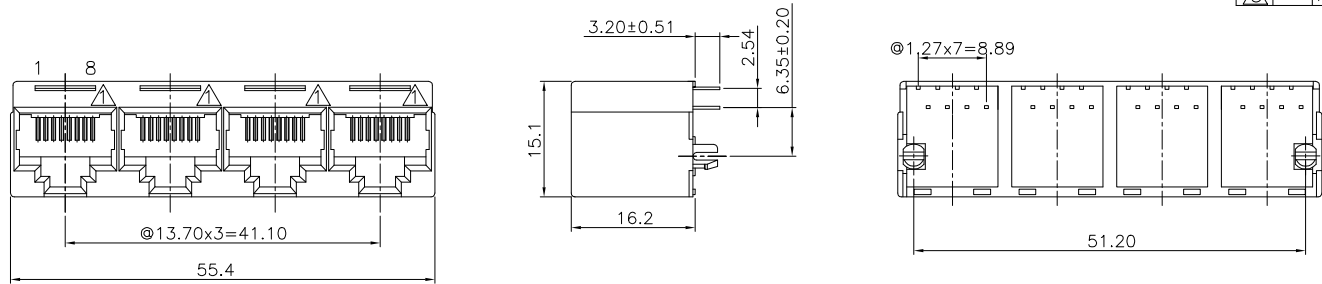

**NOTES:**

**ELECTRICAL:**

- VOLTAGE RATING : 125 VAC RMS.
- CURRENT RATING : 1.5 AMP.
- CONTACT RESISTANCE : 30 MILLIOHMS MAX.
- INSULATION RESISTANCE: 1000 MEGOHMS MIN @ 500 VDC.
- DIELECTRIC STRENGTH : 1000 VAC RMS 60Hz, 1MIN.

**MECHANICAL:**

- HOUSING MATERIAL : GLASS FILLED POLYESTER UL94V-0.
- CONTACT MATERIAL : PHOSPHOR BRONZE t=0.35mm.
- △ 3. PLATING : GOLD PLATING OVER NICKEL.
- OPERATING LIFE : 750 CYCLES MIN.
- PCB RETENTION PRE-SOLDER : 1 LB MIN.
- PCB RETENTION POST-SOLDER: 10 LBS MIN.

**ENVIRONMENTAL:**

- STORAGE : -40°C TO +85°C.
- △ 2. OPERATION: -40°C TO +85°C.

MATES WITH MODULAR PLUG CONFORMING TO FCC PART 68, SUBPART F.

PART NUMBER: E5288-30C14XXX △

- |        |        |                  |
|--------|--------|------------------|
| 1- 3u" | 2- 6u" | FREE - TIN LEAD  |
| 3-15u" | 4-30u" |                  |
| 5-50u" |        | -L - LEAD FREE △ |

DETACHED LISTS	← MM (INCH) →	DFTO Teng	DATE 7/13/99'	FULL RISE ELECTRONIC CO., LTD		
	TOLERANCES EXCEPT AS NOTED	CHKD SAMMY	DATE 2004/11/17			
	MM	MFO	DATE	TITLE TOP ENTRY GANG JACK W/O SHIELD (4 PORTS)		
	.0 ±0.20	APPVLLUSHENG	DATE 2004/11/17			
.00 ±0.15	MATERIAL :	QT'Y :	DRAWING NO. GE523036		SIZE	REV
.000 ±0.075	ANGLES ±	FINISH :	/PART NO. SEE NOTE		A3	3
THIRD ANGLE PROJECTION	SCALE : 1.5:1	DO NOT SCALE DRAWING	SHEET X		OF Y	